

产品性能

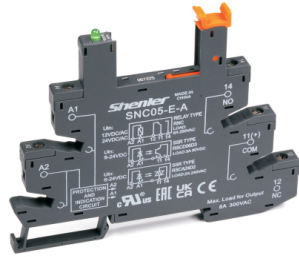

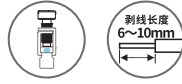



SNC05-E

型号	输入	Relay
SNC05-E-A	12~24V	12~24VDC
SNC05-E-B	48~60V	48~60VDC
SNC05-E-C	110V	60VDC
SNC05-E-D	230V	60VDC
SNC05-E-AR	12~24VDC	12~24VDC

产品性能

额定负载	电流	A	8
	电压	V	300
介质耐压	线圈/触点	V/min	4000
	触点间	V/min	2000
螺钉扭矩	Nm	0.5	
外连接导线	AWG/mm ²	20-16/0.5-1.5	
使用环境	°C	-40~+85	
重量	g	24	

配用附件表

产品型号	连接桥	标记牌	蝴蝶片
 SNC05-E	 SN20B	 SN64P	 SN20S

*SNC05-E-DR可选，功能：抗干扰功能。

外形尺寸、安装尺寸 (mm)

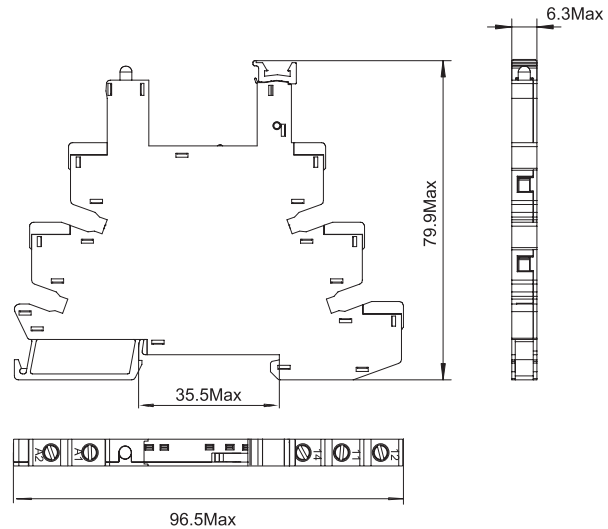

端子配置及接线图

